

iglide®

Slewing ring bearings

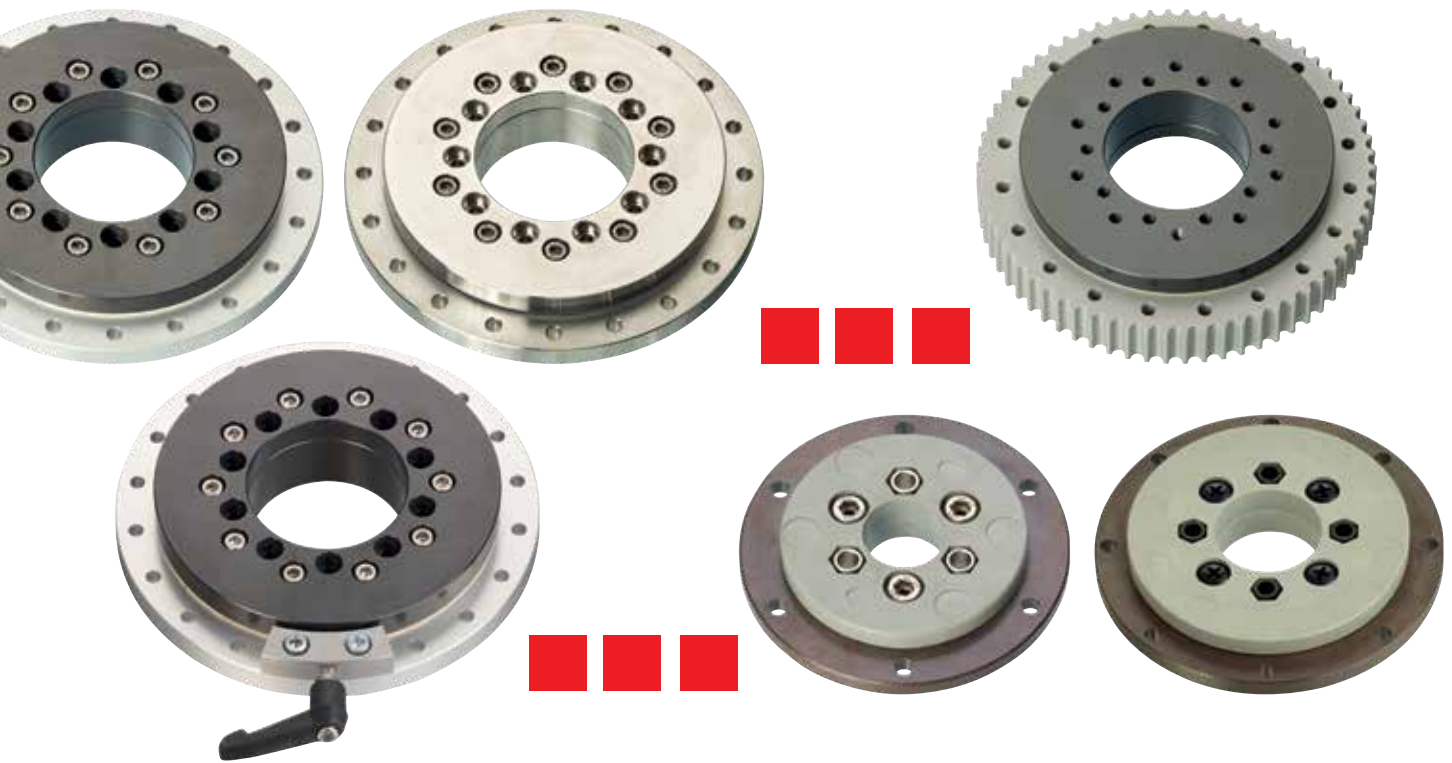

...plastics



iglide® PRT - Product overview

iglide® PRT - polymer slewing ring bearings



High torsional stability:

Type 01
▶ Page 738



With outer drive ring:

Type 01
▶ Page 739



Lightweight:

Type 02
▶ Page 740



Compact, cost-effective:

Type 04
▶ Page 742

iglide® PRT - ppolymer slewing ring bearings

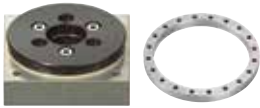

**Special geometries
and accessories**

▶ Page 748



**Universal sliding
elements**

▶ Page 754



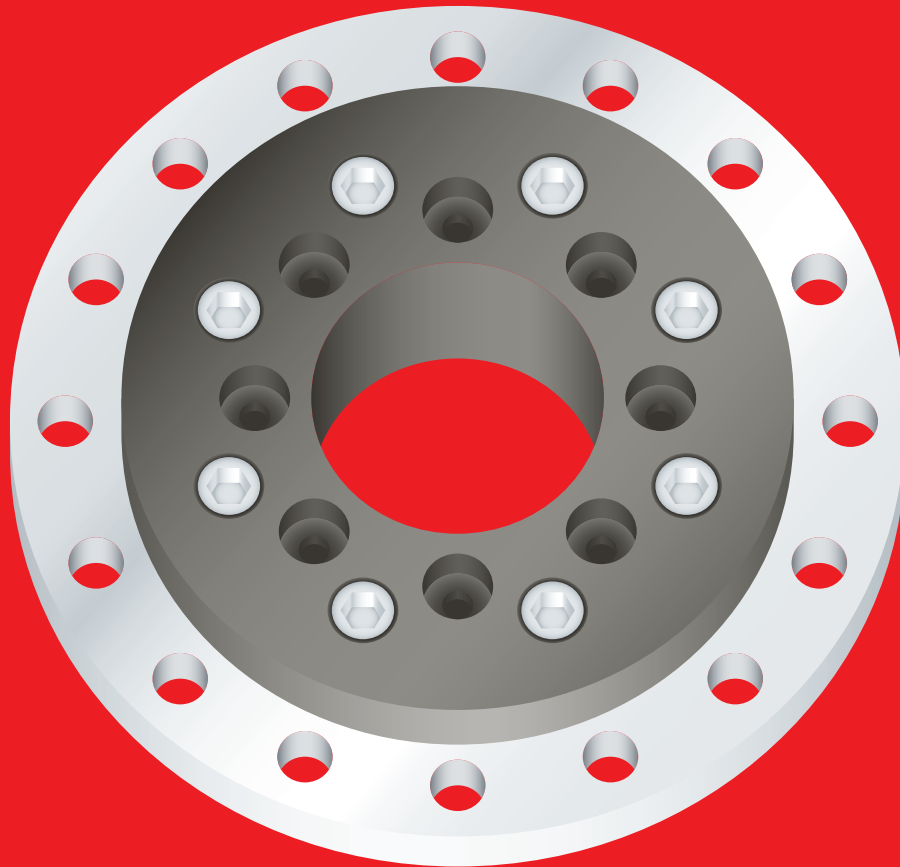

iglide® PRT - polymer slewing rings

Completely maintenance-free

Easy to install and replaceable sliding elements

High wear resistance

For very high loads and high rigidity

Stainless steel versions available

Extensive accessories

Standard range from stock





Type 01:
High rigidity
▶ Page 738

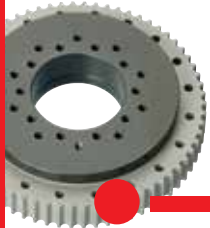

Type 01 with gear teeth:
With outer drive ring
▶ Page 739



Type 02:
Lightweight
▶ Page 740



Type 04:
Compact, lightweight
and cost effective
▶ Page 742

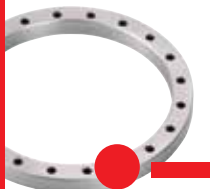

Wide range of accessories:
Special geometries and
accessories
▶ Page 748

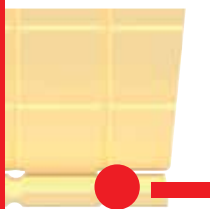

Universal sliding pads:
Customize your own
slewing ring systems
▶ Page 754

PRT - Plastic slewing ring bearing

iglide® PRT is a slewing ring bearing with the proven advantages of the igus® plastic bearings. The sliding pads made of iglide® high-performance plastics are completely self-lubricating and maintenance-free. Anodized aluminum or stainless steel housing surfaces mate with iglide® sliding pads. All fixing screws are made of stainless steel.

- Completely maintenance free
- Easy installation; replaceable sliding pads
- High wear resistance
- For high load capacity, high rigidity
- Stainless steel versions available
- Wide range of accessories available

Typical industries and applications

- Conveyors
- Automation
- Assembly stations
- Stage and lighting technology
- Renewable energy, etc



Service life calculation
▶ www.igus.com/prt-expert



Max. +356°F
min. -58°F



3 types
Ø 20–300 mm



Available from stock
Stainless steel version on request
Detailed information about delivery time online.



- Slewing ring bearings structure**
- ① **Type 01:** Hard anodized aluminum, or 316 stainless steel
 - Type 02:** iglide® J4 or A180
 - ② **Type 01 and 04:** iglide® J or H1
 - ③ **Type 01 and 02:** anodized aluminum, or 316 stainless steel

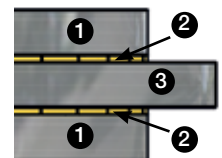

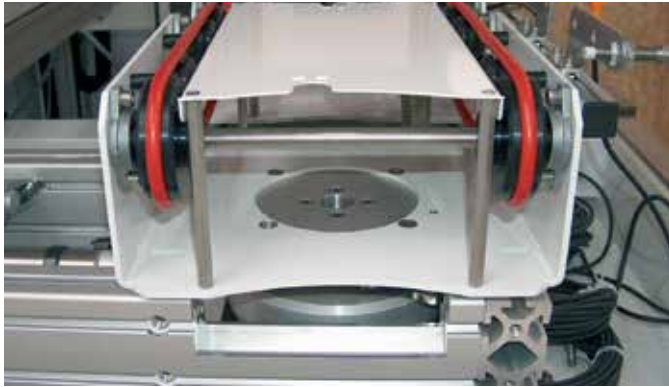

iglide® PRT-01-60 is used here in a handling/transport system for semiconductor carriers. Through a cylinder control, the PRT plastic slewing ring bearing provides a deflection at the end of the system's track.



Alfred, a food-preparation robot, scoops vegetables as it makes a salad. The robot's rotating base features a dry-running iglide® PRT slewing ring, which has been engineered with self-lubricating, maintenance-free sliding elements.



In this machine tool control panel, an iglide® plastic slewing ring bearing is used due to its freedom from external lubrication and maintenance.



The iglide® PRT-01-100 slewing ring bearing is used in an automatic welding plant in this application. It enables pivoting in the horizontal plane of the clamping device.



The self-lubricating iglide® PRT slewing ring bearing masters this job brilliantly, is lighter and in terms of purchasing is cheaper than a comparable metal rotary connector.



PRT-01-100 is used in a robot as a safer alternative to pipeline rehabilitation. The robot can safely surface blast and apply new lining systems to avoid corrosion, repair leaks and keep the system running smoothly.

Slewing ring bearings general properties

Type 01

Properties	Unit	-20	-30	-50	-60	-100	-150	-200	-300
Weight	kg	0.2	0.4	1.0	1.1	1.3	2.2	3.2	7.6
Axial load, static	lbs	3,372	6,070	8,992	11,240	12,364	17,984	22,480	33,720
Axial load, dynamic	lbs	899	1,574	2,248	3,372	3,597	5,620	6,744	20,232
Radial load, static	lbs	517	1,124	1,798	2,248	3,597	5,620	7,868	10,116
Radial load, dynamic	lbs	135	337	562	674	1,124	1,798	2,248	6,070
Rotat. speed dry running	rpm	300	250	200	200	150	100	80	50
Max. perm. tilting moment	ft•lbs	74	147	442	590	1,106	1,475	2,803	3,688

Type 02

Properties	Unit	-20-AL	-20-LC	-20-P	-30-AL	-30-LC	-30-P	-50-AL	-50-LC	-50-P	-60-AL
Weight	g	105	87	72	200	165	140	440	380	320	700
Axial load, static	lbs	2,922	2,922	2,922	5,620	5,620	5,620	7,868	7,868	7,868	10,116
Axial load, dynamic	lbs	899	899	899	1,574	1,574	1,574	2,023	2,023	2,023	2,698
Radial load, static	lbs	450	450	450	562	562	562	1,124	1,124	1,124	2,248
Radial load, dynamic	lbs	112	112	112	157	157	157	270	270	270	629
Rotat. speed dry running	rpm	250	250	250	200	180	180	120	120	120	120
Max. perm. tilting moment	ft•lbs	44	30	30	74	37	37	89	74	74	147

Type 04

Properties	Unit	-50	-60	-100	-150	-200	-300
Weight	g	225	250	370	530	680	990
Axial load, static	lbs	2,698	3,147	4,496	6,070	7,868	10,791
Axial load, dynamic	lbs	674	899	1,124	1,686	2,023	2,698
Radial load, static	lbs	562	674	337	1,461	1,798	2,248
Radial load, dynamic	lbs	169	202	337	427	562	786
Rotat. speed dry running	rpm	200	190	135	100	80	50
Max. perm. tilting moment	ft•lbs	148	184	332	479	645	885

Input Configuration Metric Imperial Actions

Operating mode
 Pivoting
 Rotating

Speed
 Frequency: 1/min
 Pivot angle β : °
 RPM: 1/min

Centre load
 Axial: N
 Radial: N

Off-centre load
 Load: N
 Resulting lever arm: mm

Your installation space
 Min. inner diameter: 20 mm
 Max. outer diameter: 450 mm

Environment
 Temperature: 20 °C
 For continuous underwater uses

Calculate

iglidur® polymer slewing ring bearings suited for your application

Standard PRT-01 Low-Cost PRT-02 High-temperature PRT-01

Configure Configure Configure



Configurator for slewing rings

The most common criteria for selecting an iglide® PRT slewing ring bearing are firstly the loads and torques to be supported and secondly the installation space available and the minimum central implementation distance required. The suitable sizes and types are selected on the basis of this data and the speed and their service life is calculated.

► www.igus.com/prt-expert

Input Configuration Metric Imperial Actions

Sizes for design PRT-02 Low-Cost suitable for your application

Calculate diameter:
 Inner diameter: 20 mm
 Outer diameter: 80 mm

Service life for your application:
 Hours: 11,846
 Cycles: 21,322,138

PRT-02-20-AL Price: 88.58 USD

Accessories and custom designs for this type: 0 Selected

Spacer ring (aluminium)
 Easy and flexible assembly. The PRT does not need to be embedded. Full load capacity.
 PRT-01-20-DR Price: 82.63 USD

Spacer ring (plastic)
 Easy and flexible assembly. The PRT does not need to be embedded. Cost effective. 1/3 of max. center load capacity, a tilt torque should be avoided.
 PRT-01-20-DRP Price: 57.72 USD

Total price: 88.58 USD

Back 1 Piece Add to shopping cart

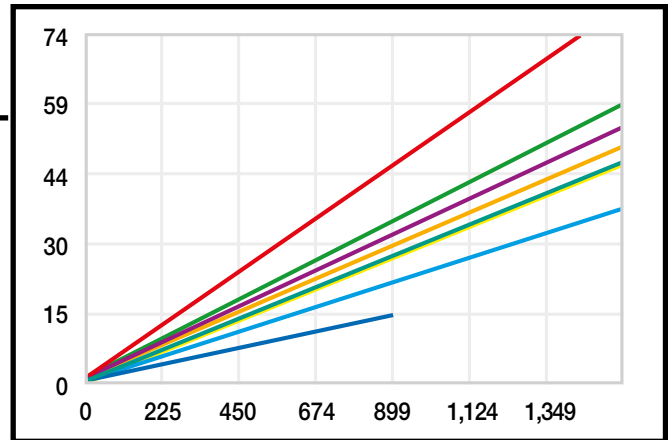
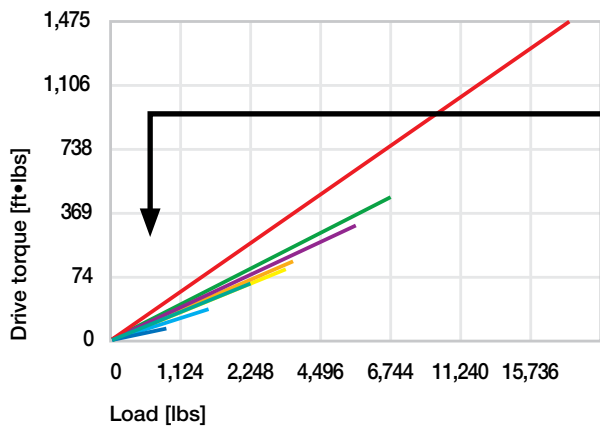

Diagram 01: Required drive torque versus applied load

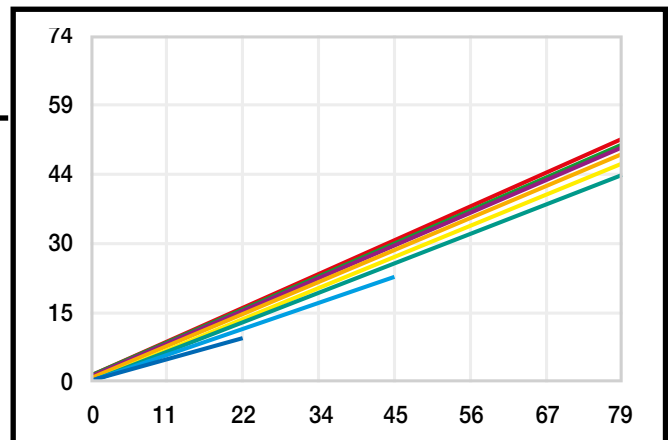
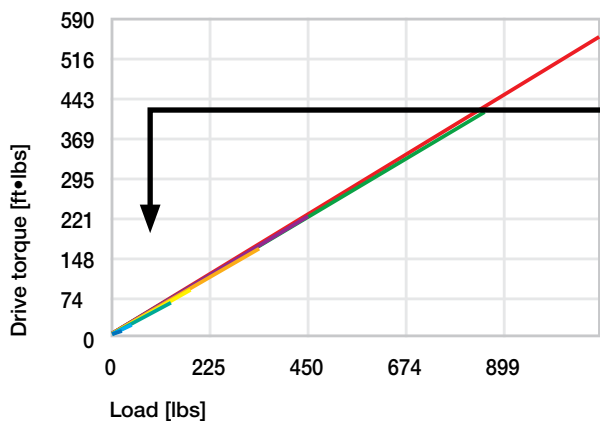

Diagram 02: Required drive torque versus applied moment

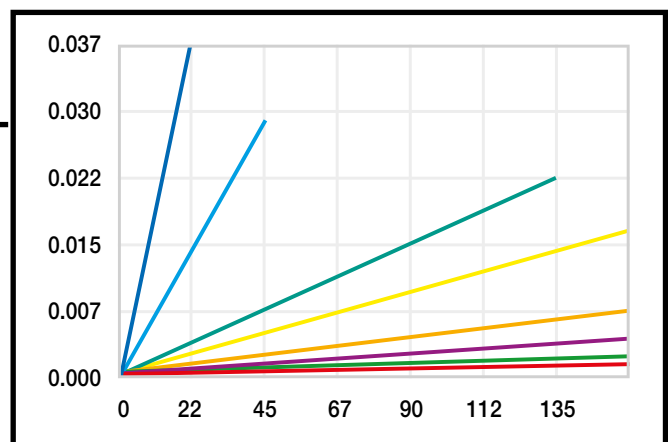
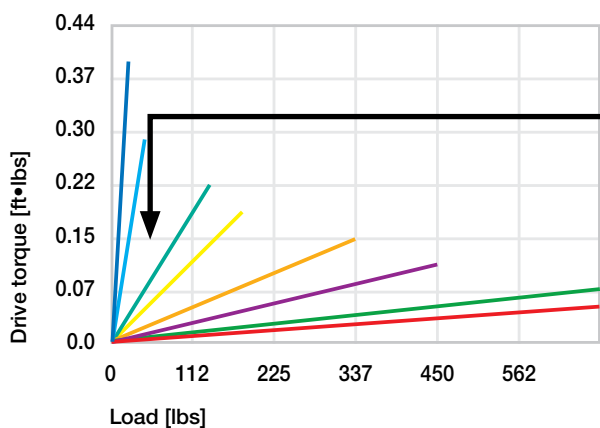

Diagram 03: Deflection versus applied tilting moment

- | | | | | | | | |
|-------------|-------------|-------------|-------------|--------------|--------------|--------------|--------------|
| — PRT-01-20 | — PRT-01-30 | — PRT-01-50 | — PRT-01-60 | — PRT-01-100 | — PRT-01-150 | — PRT-01-200 | — PRT-01-300 |
| M4, min. | M4, min. | M6, min. | M5, min. | M5, min. | M5, min. | M6, min. | M8, min. |
| 6 screws | 8 screws | 12 screws | 10 screws | 12 screws | 12 screws | 12 screws | 12 screws |

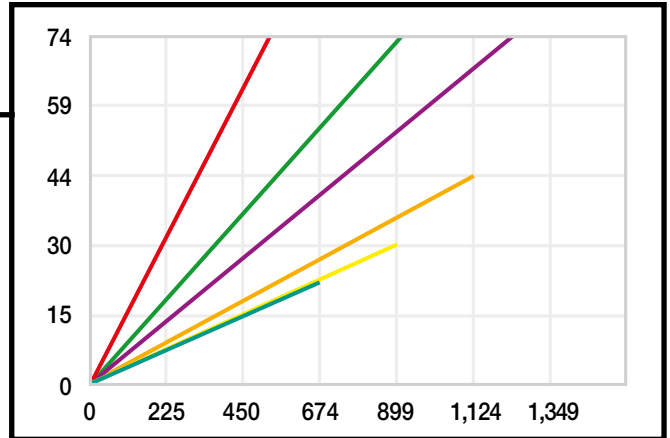
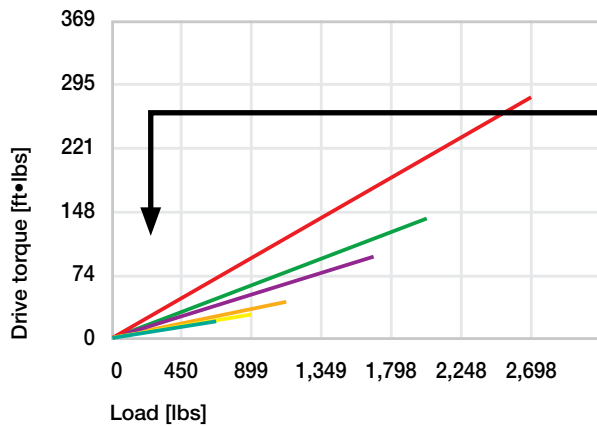

Diagram 01: Required drive torque versus applied load

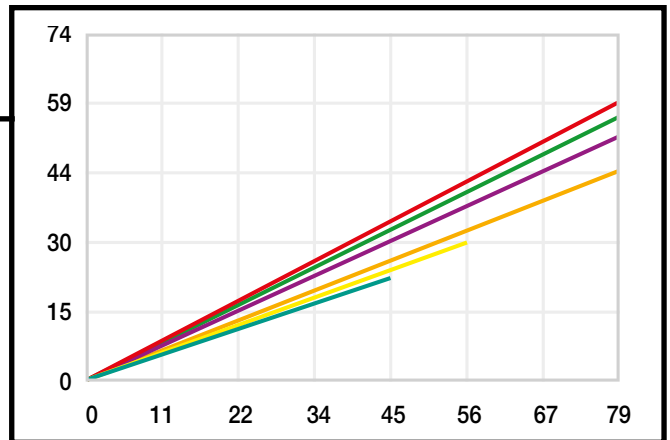
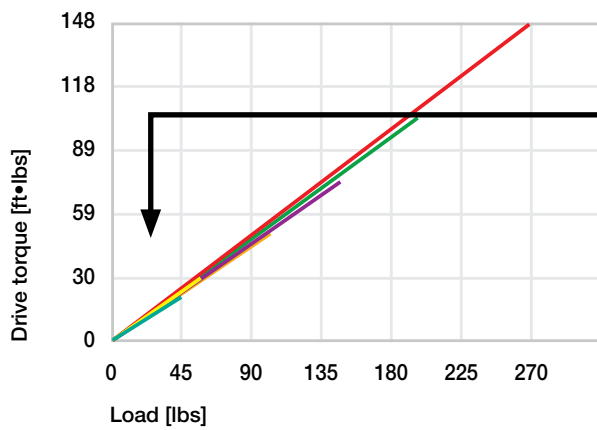

Diagram 02: Required drive torque versus applied moment

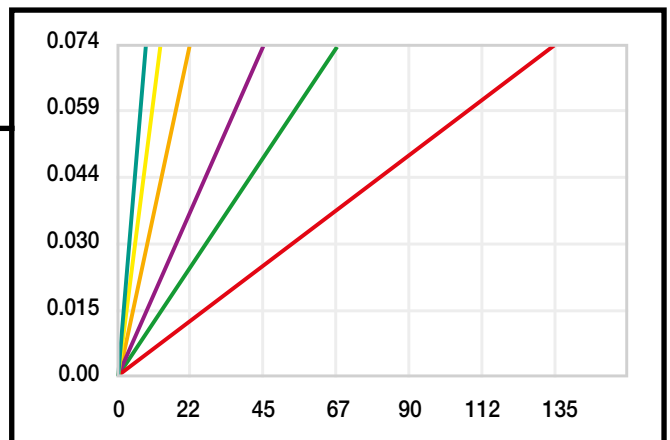
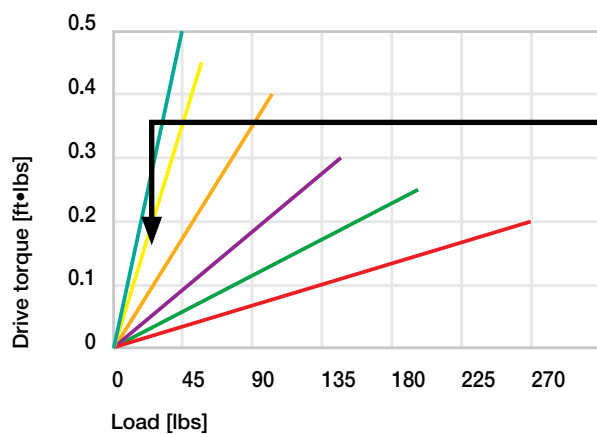

Diagram 03: Deflection versus applied tilting moment

- | | | | | | |
|-----------|-----------|------------|------------|------------|------------|
| PRT-04-50 | PRT-04-60 | PRT-04-100 | PRT-04-150 | PRT-04-200 | PRT-04-300 |
| M6, min. | M5, min. | M5, min. | M5, min. | M6, min. | M8, min. |
| 12 screws | 10 screws | 12 screws | 12 screws | 12 screws | 12 screws |



All load values assume the PRT is assembled with socket head screws (strength class 8.8) on the outside pitch circle diameter. For the assembly (using strength class 8.8 screws) of the PRT, the screws have to be inserted to a minimum thread depth of $2 \times d$ in every hole location in the outer ring. All data can be used for both lateral and horizontal assembly (including overhead installation).



Standard

High temperature
up to +356°F



Stainless steel version

ESD compliant



Order key

Type	Size	Options
PRT-01	- 30	- ES - H1
Slewing Ring	Type	Inner-Ø [mm]
	Body material	Sliding pads

Options:

Body material

Blank: Aluminum

ES: 316 stainless steel

Sliding pads

Blank: iglide® J

H1: iglide® H1,
High temperature

ESD: iglide® F2,
ESD-compliant

A180: FDA compliant

- Aluminum or stainless steel body (on request)
- Replaceable maintenance free sliding pads made from iglide® J (Standard) ► Page 193, iglide® H1 (for temperatures up to +356°F) ► Page 407, or iglide® F2 (ESD-compliant) ► Page 597 iglide® A180 (FDA compliant) ► Page 493

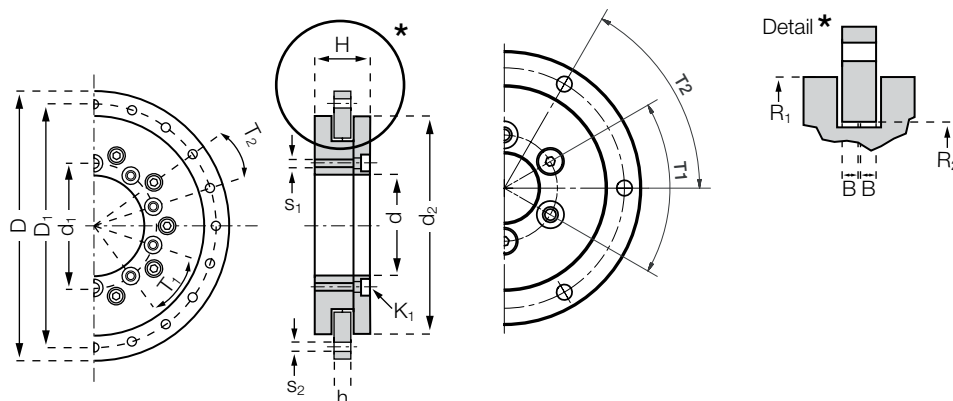

Accessories

► Page 751



All stainless steel

versions on request

Dimensions [mm]

Part No.	D ¹⁰⁾	D1	d1	d	d2 ±0.2	H	h	T1	T2	S1	S2	K1 for screw	R1	R2	B
PRT-01-20-...	80	70	31	20	60	24	8	6 x 60°	6 x 60°	M4	4.5	DIN 7984 M4	30	20	3.5
PRT-01-30-...	100	91	42.5	30	82	29	10	8 x 45°	8 x 45°	M4	4.5	DIN 7984 M4	41	29	4.5
PRT-01-50-...	150	135	65	50	120	33	10	8 x 45°	16 x 22.5°	M6	6.6	ISO 4762 M6	60	46.5	4.5
PRT-01-60-...	160	145	74	60	130	33	10	10 x 36°	20 x 18°	M5	5.5	ISO 4762 M5	65	51.5	4.5
PRT-01-100-...	185	170	112	100	160	34	12	12 x 30°	16 x 22.5°	M5	5.5	ISO 4762 M5	80	69	5.5
PRT-01-150-...	250	235	165	150	220	35	12	12 x 30°	16 x 22.5°	M5	5.5	ISO 4762 M5	110	96.5	5.5
PRT-01-200-...	300	285	215	200	274	38	15	12 x 30°	16 x 22.5°	M6	6.6	ISO 4762 M6	137	124	7.0
PRT-01-300-...	450	430	320	300	410	42	15	12 x 30°	16 x 22.5°	M8	9.0	DIN 7984 M8	205	186.6	7.0

¹⁰⁾ Tolerance according to DIN ISO 2768 mK

Please add suffix "-H1" for the high temperature version or suffix "-ESD" for ESD-compliant slewing ring bearings

Slewing ring bearing with gear teeth



Standard



Stainless steel version

- 4 standards for outer drive rings are available
 - A classic spur gear according to DIN3967
 - Commercially available belt profiles: T10, AT10, HTD8M
- The inner ring is fixed and the outer ring driven
- The outer ring carries the item to be moved
- Outer ring available in stainless steel as an option (suffix "-ES")



Order key

Type	Size	Options
PRT-01 - 30 - TO - ... - ES		
Slewing Ring	Type	Inner-Ø [mm]
	Outer drive ring	Tooth profile type
		Stainless steel version

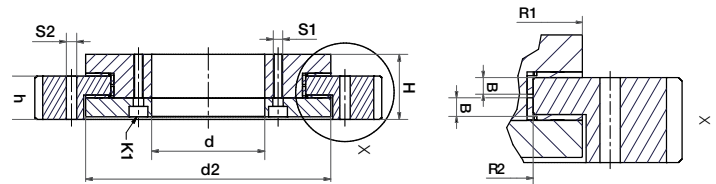
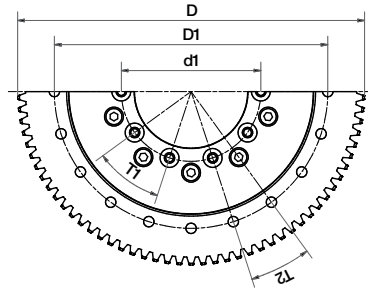

Dimensions [mm]

Part No.	D1	d1	d	d2	h	T1	T2	S1	S2	K1 for screw	R1	R2	B	H
PRT-01-20-TO...	70	31.0	20	60	18	6x60°	6x60°	M4	4.5	DIN 7984 M4	30	20.0	3.5	(26.0)
PRT-01-30-TO...	91	42.5	30	82	21	8x45°	8x45°	M4	4.5	ISO 4762 M4	41	29.0	4.5	(30.5)
PRT-01-50-TO...	135	65.0	50	120	10	8x45°	16x22.5°	M6	6.6	ISO 4762 M6	60	46.5	4.5	(33.0)
PRT-01-60-TO...	145	74.0	60	130	23	10x36°	20x18°	M5	5.5	ISO 4762 M5	65	51.5	4.5	(34.5)
PRT-01-100-TO...	170	112.0	100	160	25	12x30°	16x22.5°	M5	5.5	ISO 4762 M5	80	69.0	5.5	(36.0)
PRT-01-150-TO...	235	165.0	150	220	25	12x30°	16x22.5°	M5	5.5	ISO 4762 M5	110	96.5	5.5	(37.5)
PRT-01-200-TO...	285	215.0	200	274	30	12x30°	16x22.5°	M6	7.0	ISO 4762 M6	137	124.0	7.0	(41.5)
PRT-01-300-TO...	430	320.0	300	410	30	12x30°	16x22.5°	M8	9.0	ISO 4762 M8	205	186.5	8.5	(43.5)

Spur gearing DIN3967

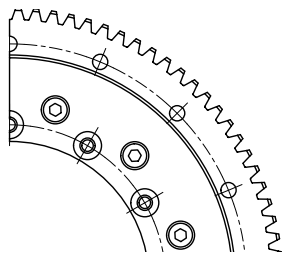

D	m	z	Part No. add-on
(88)	-	42	...-ST
(112)	2	54	...-ST
(160)	2	78	...-ST
(184)	2	90	...-ST
(196)	2	96	...-ST
(256)	2	126	...-ST
(308)	2	152	...-ST
(462)	3	152	...-ST

Toothed belt profile AT10

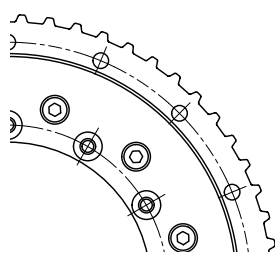

D	z	Part No. add-on
(87.25)	28	...-AT10
(106.4)	34	...-AT10
(157.3)	50	...-AT10
(163.8)	52	...-AT10
(189.2)	60	...-AT10
(252.9)	80	...-AT10
(303.9)	96	...-AT10
(456.7)	144	...-AT10

Toothed belt profile T10

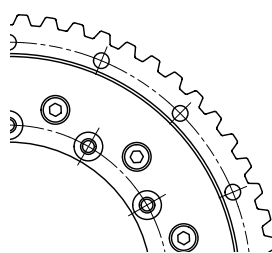

D	z	Part No. add-on
(87.25)	28	...-T10
(106.4)	34	...-T10
(157.3)	50	...-T10
(163.8)	52	...-T10
(189.2)	60	...-T10
(252.9)	80	...-T10
(303.9)	96	...-T10
(456.7)	144	...-T10

Toothed belt profile HTD5M (-20)/HTD8M

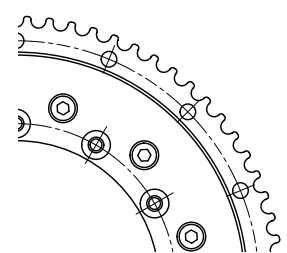

D	z	Part No. add-on
(81.25)	52	...-HTD5M
(110.7)	44	...-HTD8M
(161.6)	64	...-HTD8M
(166.7)	66	...-HTD8M
(187.1)	74	...-HTD8M
(253.3)	100	...-HTD8M
(304.3)	120	...-HTD8M
(457.1)	180	...-HTD8M



Standard



Stainless steel version



Low-cost version



Solid plastic version

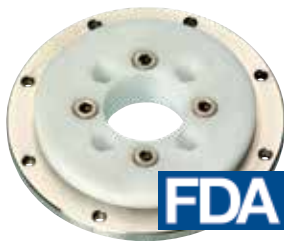

FDA

FDA compliant



Order key

Type	Size	Options
PRT-02	- 20	- AL - A180
Slewing Ring	Type	Inner-Ø [mm]
	Body material	Outer rings

Options:

Body material

AL: Aluminum

ES: 316 Stainless steel

LC: Low-cost

P: Solid plastic

Outer rings

Blank: iglide® J4

A180: iglide® A180,

FDA-compliant

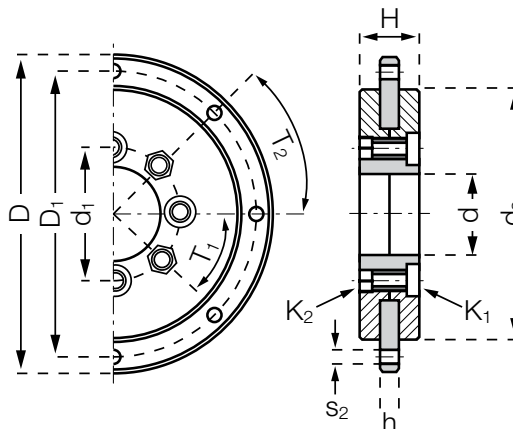

- Slewing ring with extremely low weight
- Outer ring made from anodized aluminum, 316 stainless steel (on request) or iguton G
- Outer rings made from iglide® J4 or FDA-compliant iglide® A180
- 30 % lighter with plastic screws

Dimensions [mm]

Part No.	D	D1	d1	d	d2	H	h	T1	T2	S2	K1 for screw	K2 for screw nut
PRT-02-20-□	80	70	31	20	60	16	5	6 x 60°	6 x 60°	4.5	DIN 6912 M5	DIN 439 M5
PRT-02-30-□	100	91	42.5	30	80	19	6	8 x 45°	8 x 45°	4.5	DIN 7984 M5	DIN 439 M5
PRT-02-50-□	150	135	65	50	120	20	6	16 x 22.5°	8 x 45°	6.6	Through hole 6.5 mm	
PRT-02-60-□	160	145	86.0	60	130	30	10	12 x 30°	20 x 18°	5.5	Counter-bore Ø16 and 6.5 deep	

Please add suffix "-A180" for FDA-compliant version



All stainless steel versions on request

Notes

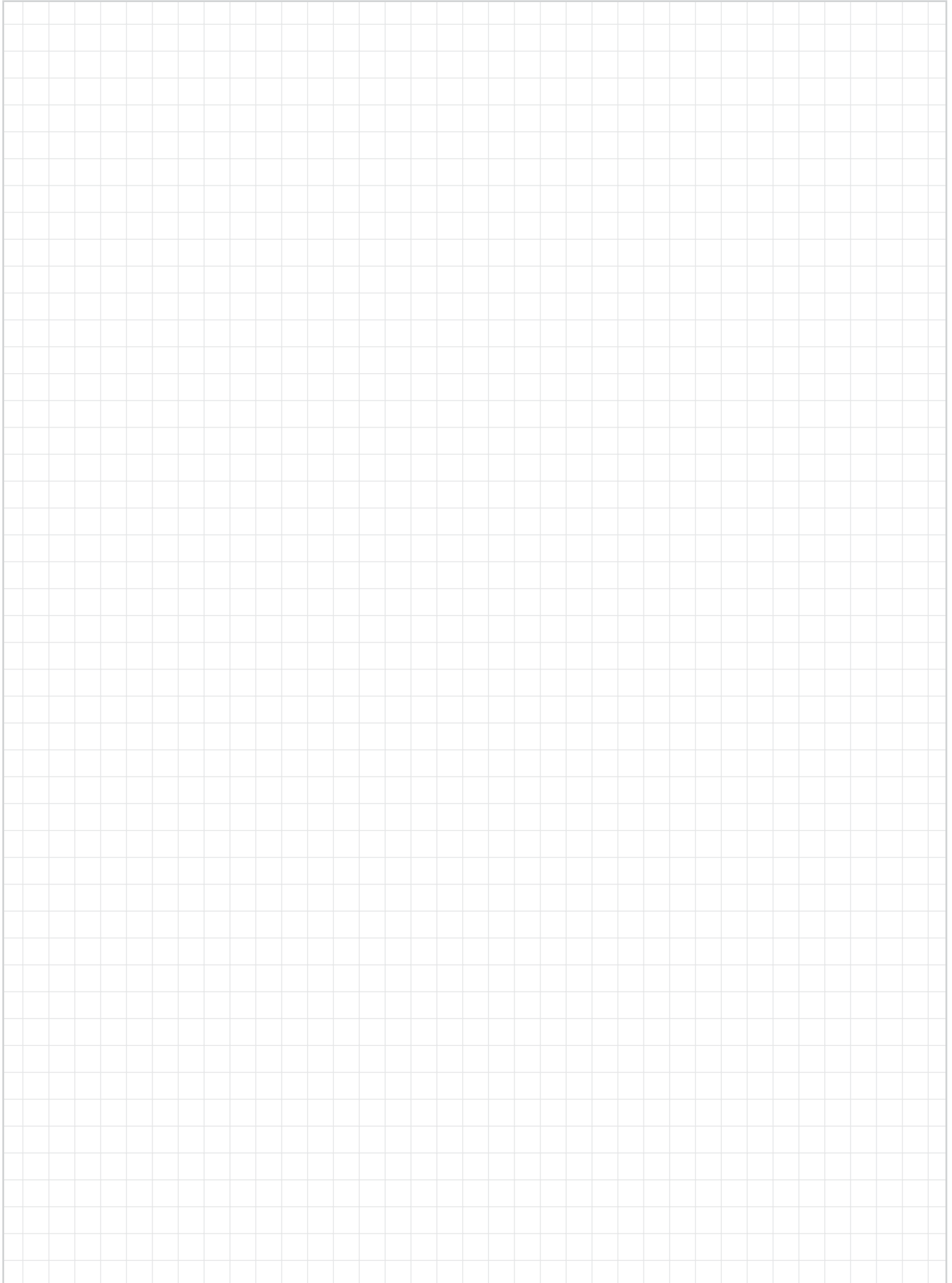



Order key

Type Size

PRT-04 - 50

Slewing Ring

Type

Inner-Ø [mm]

- Available with diameters from 50mm to 300mm
- 60% lighter and 50% more compact compared to PRT-01
- 20% more cost-effective compared to PRT-01
- Wear-resistant, self-lubricating and maintenance-free iglide® sliding elements

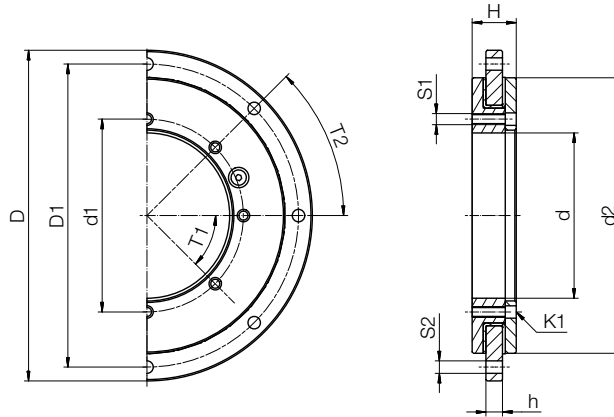

Dimensions [mm]

Part No.	D	D1	d1	d	d2	H	h	T1	T2	S1	S2	K1
PRT-04-50	110	100	60	50	90	16	6	8 x 45°	8 x 45°	M4	Ø 4.5	Ø 4.5
PRT-04-60	120	110	70	60	100	16	6	8 x 45°	8 x 45°	M4	Ø 4.5	Ø 4.5
PRT-04-100	160	150	110	100	140	16	6	8 x 45°	8 x 45°	M4	Ø 4.5	Ø 4.5
PRT-04-150	210	200	160	150	190	16	6	16 x 22.5°	16 x 22.5°	M4	Ø 4.5	Ø 4.5
PRT-04-200	260	250	210	200	240	16	6	16 x 22.5°	16 x 22.5°	M4	Ø 4.5	Ø 4.5
PRT-04-300	360	350	310	300	340	16	6	16 x 22.5°	16 x 22.5°	M4	Ø 4.5	Ø 4.5

for screw



With outer spacing ring



With large outer spacing ring



Order key

Type	Size	Options
PRT-04 - 50 - M4		
Slewing Ring	Type	Inner-Ø [mm]
		Thread

- Available for PRT-01 and PRT-04
- Maintenance-free and wear-resistant
- 20 Easy to fit
- Replaceable sliding elements

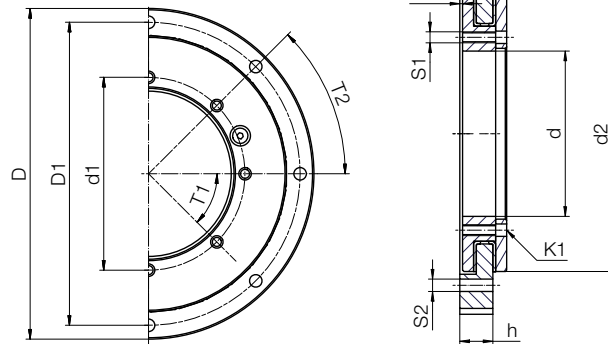

Dimensions [mm]

Part No.	D	D1	d1	d	d2	H	h1	h	T1	T2	S1	S2	K1
													for screw
With M4 thread in outer ring													
PRT-04-50-M4	110	100	60	50	90	16	-	6	8 x 45°	8 x 45°	M4	M4	Ø 4.5
PRT-04-60-M4	120	110	70	60	100	16	-	6	8 x 45°	8 x 45°	M4	M4	Ø 4.5
PRT-04-100-M4	160	150	110	100	140	16	-	6	8 x 45°	8 x 45°	M4	M4	Ø 4.5
PRT-04-150-M4	210	200	160	150	190	16	-	6	16 x 22.5°	16 x 22.5°	M4	M4	Ø 4.5
PRT-04-200-M4	260	250	210	200	240	16	-	6	16 x 22.5°	16 x 22.5°	M4	M4	Ø 4.5
PRT-04-300-M4	360	350	310	300	340	16	-	6	16 x 22.5°	16 x 22.5°	M4	M4	Ø 4.5
With enlarged outer ring													
PRT-04-50-G	150	135	60	50	90	16	-	6	8 x 45°	16 x 22.5°	M4	Ø 6.6	Ø 4.5
PRT-04-60-G	160	160	70	60	100	16	-	6	8 x 45°	20 x 18°	M4	Ø 5.5	Ø 4.5
PRT-04-100-G	185	185	110	100	140	16	-	6	8 x 45°	16 x 22.5°	M4	Ø 4.5	Ø 4.5
PRT-04-150-G	250	250	160	150	190	16	-	6	16 x 22.5°	16 x 22.5°	M4	Ø 4.5	Ø 4.5
PRT-04-200-G	300	300	210	200	240	16	-	6	16 x 22.5°	16 x 22.5°	M4	Ø 5.5	Ø 4.5
PRT-04-300-G	450	450	310	300	340	16	-	6	16 x 22.5°	16 x 22.5°	M4	Ø 9.0	Ø 4.5
With outer spacing ring													
PRT-04-50-DRI	110	100	60	50	90	17	1	12	8 x 45°	8 x 45°	M4	Ø 4.5	Ø 4.5
PRT-04-60-DRI	120	110	70	60	100	17	1	12	8 x 45°	8 x 45°	M4	Ø 4.5	Ø 4.5
PRT-04-100-DRI	160	150	110	100	140	17	1	12	8 x 45°	8 x 45°	M4	Ø 4.5	Ø 4.5
PRT-04-150-DRI	210	200	160	150	190	17	1	12	16 x 22.5°	16 x 22.5°	M4	Ø 4.5	Ø 4.5
PRT-04-200-DRI	260	250	210	200	240	17	1	12	16 x 22.5°	16 x 22.5°	M4	Ø 4.5	Ø 4.5
PRT-04-300-DRI	360	350	310	300	340	17	1	12	16 x 22.5°	16 x 22.5°	M4	Ø 4.5	Ø 4.5



Order key

Type Size Options

PRT-04-50-DP

Slewing Ring	Type	Inner-Ø [mm]	Drive pin
--------------	------	--------------	-----------

- Easy replacement and extension: modular construction kit design
- East drive pin for couplings
- Adjustable with manual clamps

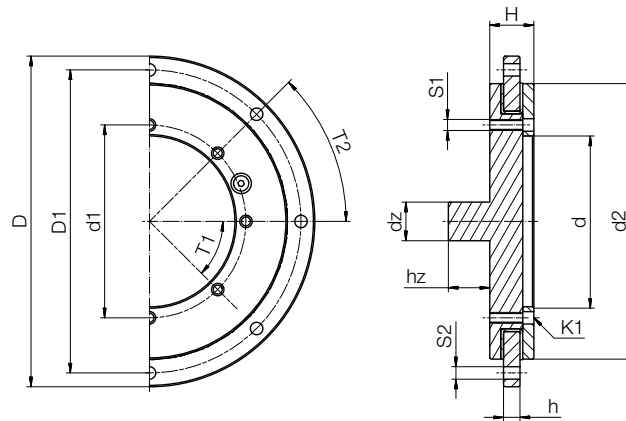

Dimensions [mm]

Part No.	D	D1	d1	d	d2	hz	H	h	T1	T2	S1	S2	K1
PRT-04-50-DP	110	100	60	52	90	15	16	6	8 x 45°	8 x 45°	M4	Ø 4.5	Ø 4.5
PRT-04-60-DP	120	110	70	62	100	15	16	6	8 x 45°	8 x 45°	M4	Ø 4.5	Ø 4.5
PRT-04-100-DP	160	150	110	102	140	15	16	6	8 x 45°	8 x 45°	M4	Ø 4.5	Ø 4.5
PRT-04-150-DP	210	200	160	152	190	15	16	6	16 x 22.5°	16 x 22.5°	M4	Ø 4.5	Ø 4.5
PRT-04-200-DP	260	250	210	202	240	15	16	6	16 x 22.5°	16 x 22.5°	M4	Ø 4.5	Ø 4.5
PRT-04-300-DP	360	350	310	302	340	15	16	6	16 x 22.5°	16 x 22.5°	M4	Ø 4.5	Ø 4.5

for screw



Order key

Type	Size	Options
PRT-04-50-TO-□		
Slewing Ring	Type	Inner-Ø [mm]
	Outer drive ring	Tooth profile type

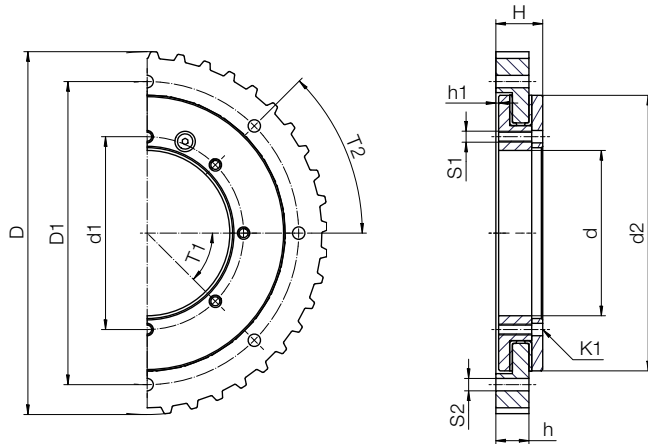

- Easy replacement and extension: modular construction kit design
- Driving the easy way with gear profiles
- Adjustable with manual clamps

Dimensions [mm]

Part No.	D1	d1	d	d2	H	h1	T1	T2	S1	S2	K1
PRT-04-50-TO-□	100	60	50	90	17	1	8 x 45°	8 x 45°	M4	Ø 4.5	Ø 4.5
PRT-04-60-TO-□	110	70	60	100	17	1	8 x 45°	8 x 45°	M4	Ø 4.5	Ø 4.5
PRT-04-100-TO-□	150	110	100	140	17	1	8 x 45°	8 x 45°	M4	Ø 4.5	Ø 4.5
PRT-04-150-TO-□	200	160	150	190	17	1	16 x 22.5°	16 x 22.5°	M4	Ø 4.5	Ø 4.5
PRT-04-200-TO-□	250	210	200	240	17	1	16 x 22.5°	16 x 22.5°	M4	Ø 4.5	Ø 4.5
PRT-04-300-TO-□	350	310	300	340	17	1	16 x 22.5°	16 x 22.5°	M4	Ø 4.5	Ø 4.5

Toothed belt profile AT10

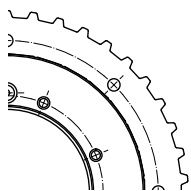

D	z	Part No. add-on
118.9	38	...-AT10
131.7	42	...-AT10
169.9	54	...-AT10
220.8	70	...-AT10
271.7	86	...-AT10
370.4	117	...-AT10

Toothed belt profile T10

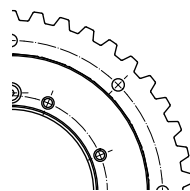

D	z	Part No. add-on
118.9	38	...-T10
131.7	42	...-T10
169.9	54	...-T10
220.8	70	...-T10
271.7	86	...-T10
370.4	117	...-T10

Toothed belt profile HTD5M

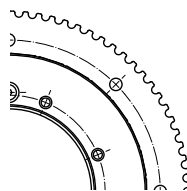

D	z	Part No. add-on
120	76	...-HTD5M
131	83	...-HTD8M
170.9	108	...-HTD8M
221.8	140	...-HTD8M
271.2	171	...-HTD8M
371.4	234	...-HTD8M



- High wear resistance
- Replaceable sliding elements
- For high loads and high rigidity



Order key

Type	Size	Options		
PRT-04 - 50 - ES - H1				
Slewing Ring	Type	Inner-Ø [mm]	Body material	Sliding elements

Options:

Body material
Blank: Aluminum
ES: 316 Stainless steel

Sliding elements

Blank: iglide® J
H1: iglide® H1, high temperature
F2: iglide® F2, ESD-compliant (only in conjunction with stainless steel)
A180: iglide® A180, FDA-compliant

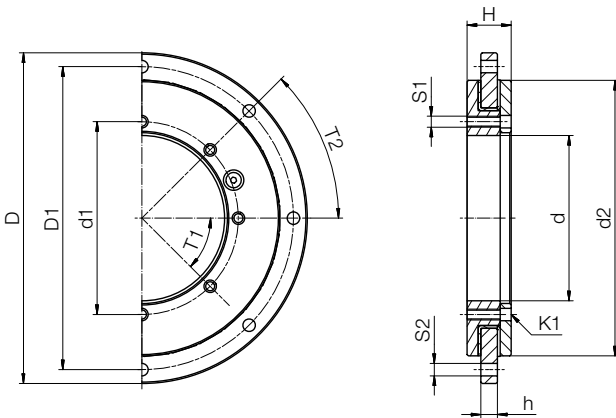

Dimensions [mm]

Part No.	D	D1	d1	d	d2	H	h	T1	T2	S1	S2	K1
PRT-04-50-ES	110	100	60	50	90	16	6	8 x 45°	8 x 45°	M4	Ø 4.5	Ø 4.5
PRT-04-60-ES	120	110	70	60	100	16	6	8 x 45°	8 x 45°	M4	Ø 4.5	Ø 4.5
PRT-04-100-ES	160	150	110	100	140	16	6	8 x 45°	8 x 45°	M4	Ø 4.5	Ø 4.5
PRT-04-150-ES	210	200	160	150	190	16	6	16 x 22.5°	16 x 22.5°	M4	Ø 4.5	Ø 4.5
PRT-04-200-ES	260	250	210	200	240	16	6	16 x 22.5°	16 x 22.5°	M4	Ø 4.5	Ø 4.5
PRT-04-300-ES	360	350	310	300	340	16	6	16 x 22.5°	16 x 22.5°	M4	Ø 4.5	Ø 4.5

Slot nut profile - type 04



- Available for PRT-01 and PRT-04
- Fast assembly
- Easy positioning with no additional holes



Order key

Type Size Options

PRT-04 - 50 - T

Slewing Ring	Type	Inner-Ø [mm]	Body material
--------------	------	--------------	---------------

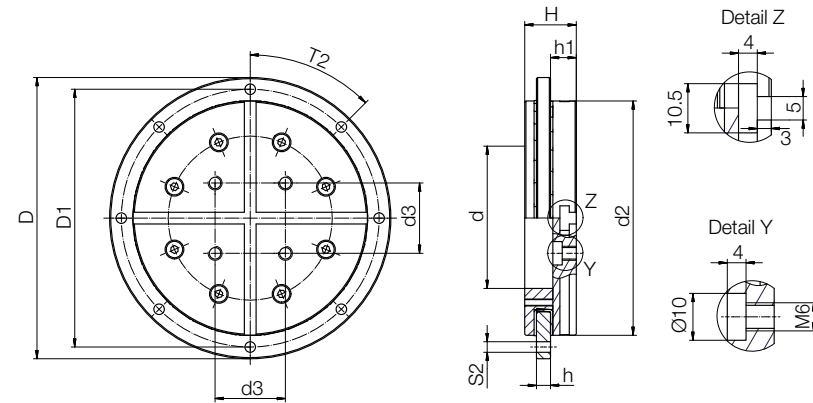

Slot nut profile up to size 60

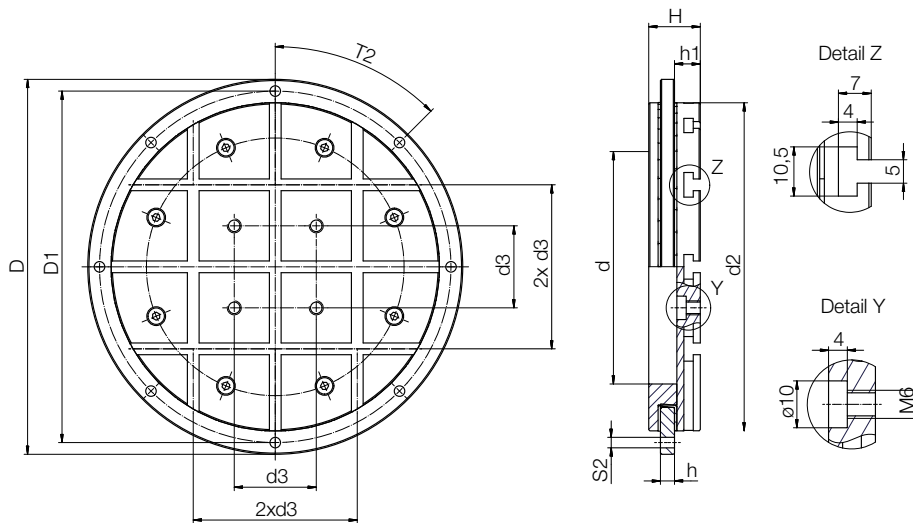

Slot nut profile from size 100

Dimensions [mm]

Part No.	D	D1	d1	d	d2	H	h	h1	T2	S2
PRT-04-50-T	110	100	60	50	90	22	6	11	8 x 45°	Ø 4.5
PRT-04-60-T	120	110	70	60	100	22	6	11	8 x 45°	Ø 4.5
PRT-04-100-T	160	150	110	100	140	22	6	11	8 x 45°	Ø 4.5
PRT-04-150-T	210	200	160	150	190	22	6	11	16 x 22.5°	Ø 4.5
PRT-04-200-T	260	250	210	200	240	22	6	11	16 x 22.5°	Ø 4.5
PRT-04-300-T	360	350	310	300	340	22	6	11	16 x 22.5°	Ø 4.5

Type 01

Slewing ring bearing with square flange for direct mounting on flat surfaces

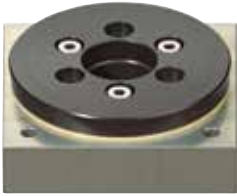

- No intake-hole necessary
- No separate distance ring
- Fix with only 4 screws

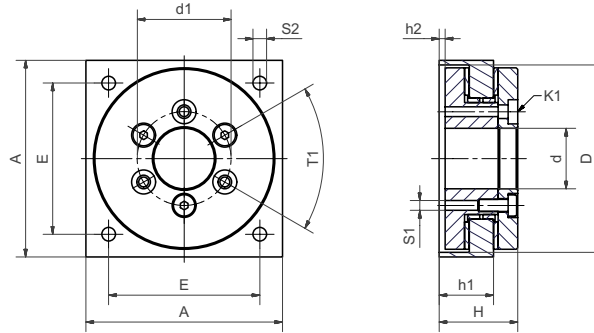

Dimensions [mm]

Part No.	d	d1	d2	D	A	E	H	h1	h2	T1	S1	S2	K1 for screw
PRT-01-20-SQ	20	31	60	62	65	50	26	18	2	6 x 60°	M4	4.5	DIN 7984 M4
PRT-01-30-SQ	30	42.5	82	84	85	65	30.5	10	1.5	8 x 45°	M4	4.5	DIN 7984 M4
PRT-01-50-SQ	50	65	120	150	125	100	23.0	10	0.5	8 x 45°	M6	6.6	ISO 4762 M6

Slewing ring with collar clamp

The slewing ring PRT-01-30 a collar ring including clamp function for 30h7 tolerance shafts.



- For simple handling designs
- Quick and easy assembly
- Max. torque moment: 5 Nm

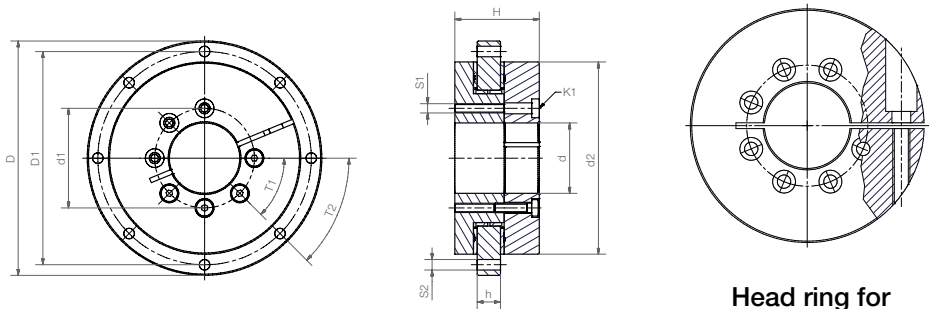

Slewing ring with collar clamp PRT-01-30-C

Head ring for PRT-01-30-C

Dimensions [mm]

Part No.	D	D1	d1	d	d2	H	h	T1	T2	S1	S2	K1 for screw
PRT-01-20-C	80	70	31	20	60	33	8	4 x 60°	4 x 60°	M4	4.5	DIN 7984 M4
PRT-01-30-C	100	91	42.5	30	82	36	10	6 x 45°	8 x 45°	M4	4.5	DIN 7984 M4

Type 01

Slewing ring bearing with dust seal (-D: one-sided, -DD: both-sided)

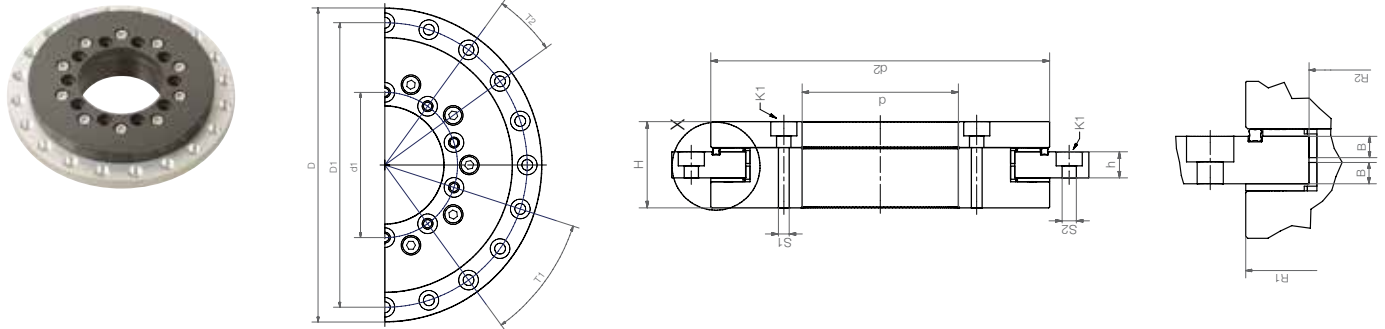

Dimensions [mm]

Part No.	D ¹⁰⁾	D1	d1	d	d2 ±0.2	H	h	T1	T2	S1	S2	for screw			
												K1	R1	R2	B
PRT-01-60-D/DD	160	145	74	60	130	33	10	10 x 36°	20 x 18°	M5	5.5	ISO 4762 M5	65	51.5	4.5
PRT-01-100-D/DD	185	170	112	100	160	34	12	12 x 30°	16 x 22.5°	M5	5.5	ISO 4762 M5	80	69	5.5

¹⁰⁾ Tolerance according to DIN ISO 2768 mK

Slewing ring bearing with angle stop – easily adjustable

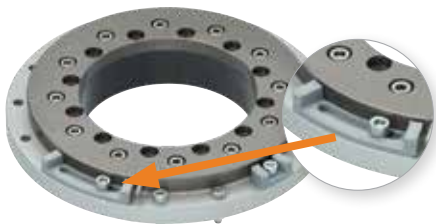

- Angle range in 2° steps
- Quick adjustment of the stop
- Load ratings identical to standard type 01

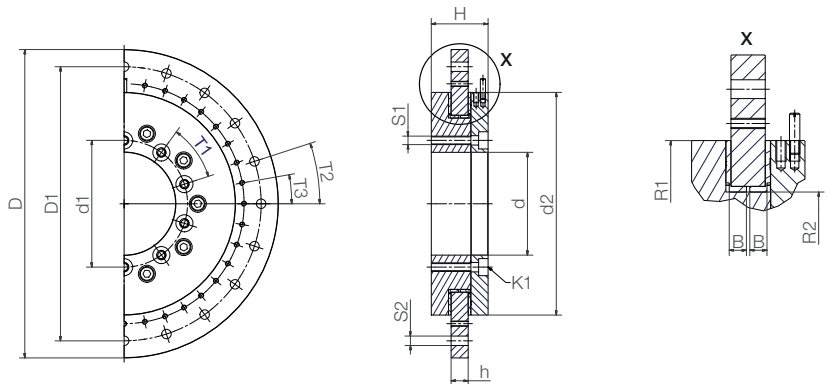

Dimensions [mm]

Part No.	D ¹⁰⁾	D1	d1	d	d2 ±0.2	H	h	T1	T2	S1	S2	for screw			
												K1	R1	R2	B
PRT-01-20-AA	80	70	31.0	20	60	24	8	6 x 60°	6 x 60°	M4	4.5	DIN 7984 M4	30	20	3.5
PRT-01-30-AA	100	91	42.5	30	82	29	10	8 x 45°	8 x 45°	M4	4.5	DIN 7984 M4	41	29	4.5
PRT-01-50-AA	150	135	65.0	50	120	33	10	8 x 45°	16 x 22.5°	M6	6.6	ISO 4762 M6	60	46.5	4.5
PRT-01-60-AA	160	145	74.0	60	130	33	10	10 x 36°	20 x 18°	M5	5.5	ISO 4762 M5	65	51.5	4.5
PRT-01-100-AA	185	170	112.0	100	160	34	12	12 x 30°	16 x 22.5°	M5	5.5	ISO 4762 M5	80	69	5.5
PRT-01-150-AA	250	235	165.0	150	220	35	12	12 x 30°	16 x 22.5°	M5	5.5	ISO 4762 M5	110	96.5	5.5
PRT-01-200-AA	300	285	215.0	200	274	38	15	12 x 30°	16 x 22.5°	M6	6.6	ISO 4762 M6	137	124	7.0
PRT-01-300-AA	450	430	320.0	300	410	42	15	12 x 30°	16 x 22.5°	M8	9.0	DIN 7984 M8	205	186.6	7.0

¹⁰⁾ Tolerance according to DIN ISO 2768 mK

Type 01

Anglw limit kit

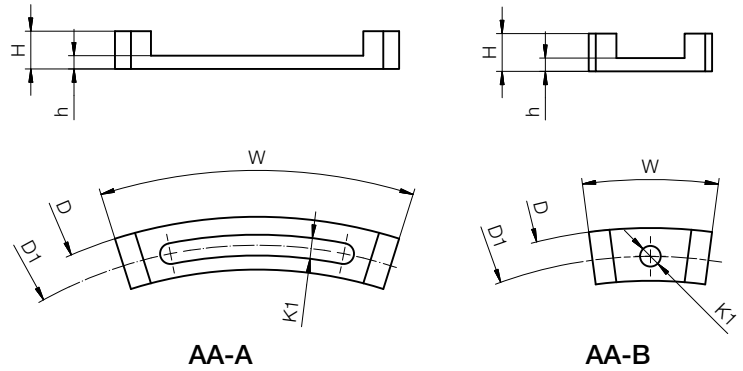

Dimensions [mm]

Part No.	Part No. kit	D Ø	D1 Ø	H	h	K1 Ø	W [°]
PRT-01-20-AA-A	PRT-01-20-AA-KIT	80	70	6.5	2.8	4.5	90.0
PRT-01-20-AA-B		80	70	6.5	2.8	4.5	30.0
PRT-01-30-AA-A	PRT-01-30-AA-KIT	100	91	8.0	2.8	4.5	70.0
PRT-01-30-AA-B		100	91	8.0	2.8	4.5	25.0
PRT-01-50-AA-A	PRT-01-50-AA-KIT	150	135	10.0	4.0	6.6	45.0
PRT-01-50-AA-B		150	135	10.0	4.0	6.6	25.0
PRT-01-60-AA-A	PRT-01-60-AA-KIT	160	145	10.0	3.5	5.5	35.0
PRT-01-60-AA-B		160	145	10.0	3.5	5.5	20.0
PRT-01-100-AA-A	PRT-01-100-AA-KIT	185	170	9.5	3.5	5.5	37.5
PRT-01-100-AA-B		185	170	9.5	3.5	5.5	15.0
PRT-01-150-AA-A	PRT-01-150-AA-KIT	250	235	10.0	3.5	5.5	35.0
PRT-01-150-AA-B		250	235	10.0	3.5	5.5	15.0
PRT-01-200-AA-A	PRT-01-200-AA-KIT	300	285	10.0	4.0	6.6	35.0
PRT-01-200-AA-B		300	285	10.0	4.0	6.6	15.0
PRT-01-300-AA-A	PRT-01-300-AA-KIT	450	430	12.0	5.0	6.6	35.0
PRT-01-300-AA-B		450	430	12.0	5.0	6.6	15.0

Slewing rings for manual adjustment



- With hard wheel for easy adjustment
- Optional manual clamp and position indicator available
- Ideal for fast and secure positioning

Dimensions [mm]

Part No.	ØT	ØS	ØP	ØF	L1	L2	B1	B2	B3	H1	S1	S2	G1	G2
PRT-01-50 HK-PA-HR	30	10	82	42.5	100.5	12	45	19.5	6	110.5	55	20	M4	8 x M4

For Type 01

Slewing ring bearing with enlarged outer ring

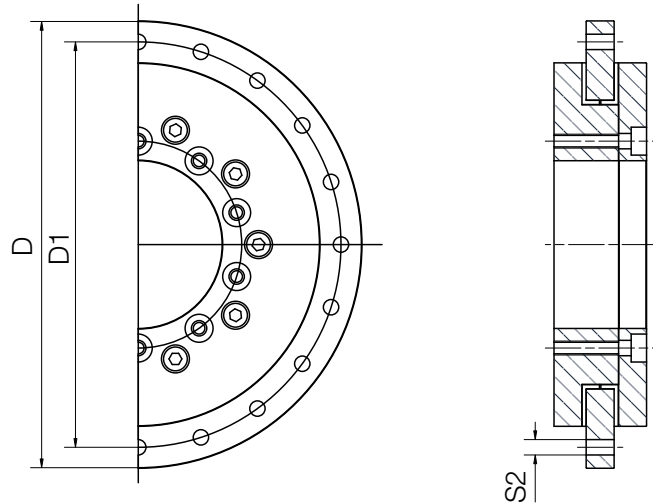

Dimensions [mm] – other dimensions similar to standard type PRT-01 ► page 650

Part No. ¹¹⁾	D	D1	S2
PRT-01-100-M-ARG	205	185	5.5
PRT-01-100-M-ARGG	205	185	M6
PRT-01-100-M-ARGS	205	185	5.5
PRT-01-200-M-ARG	320	300	7.0
PRT-01-200-M-ARGG	320	300	M8
PRT-01-200-M-ARGS	320	300	7.0

¹¹⁾ Ending: -G standard, -GG thread- or -GS counter-bore

PRT with assembled drive pin

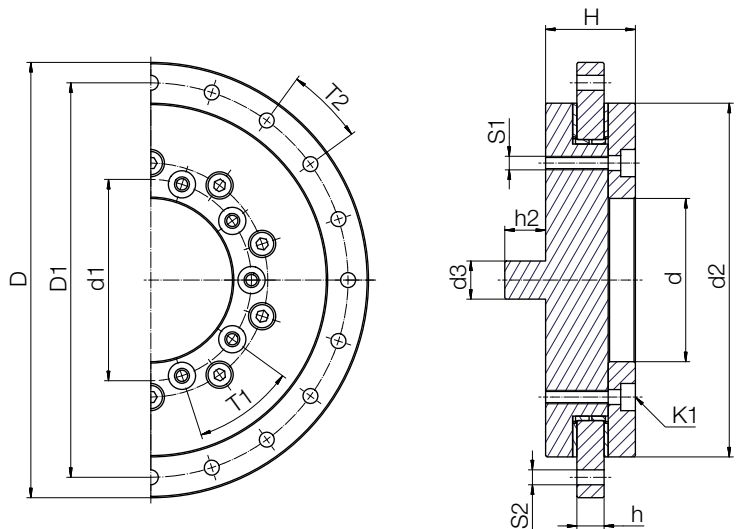

Dimensions [mm]

Part No.	D	D1	d1	d	d2	d2- tolerance	H	h	T1	T2	S1	S2	K1	R1	R2	B	h2
PRT-04-60-DP	160	145	74	60	130	±0.2	33	10	10 x 36°	20 x 18°	M5	Ø 5.5	M5	65	51.5	4.5	15

Manual clamp

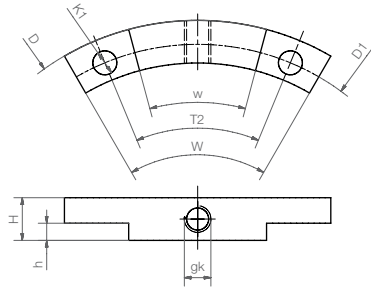

PRT-HK-30

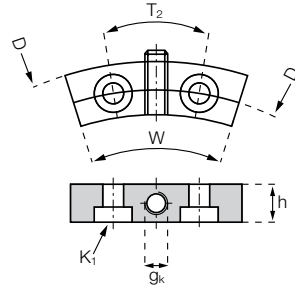

PRT-HK-60/100/200



PRT with fitted manual clamp

- With 1 Nm screw torque, a holding torque up to 10 Nm is possible
- Easy to screw onto outer ring

Dimensions [mm]

Part No.	D	D1	T2	K1 for screw	H	h	gk	W
PRT-HK-30	100	91	45°	Ø 4.5	8	3.2	M5	60°
PRT-HK-60	160	145	18°	DIN 7984 M5	–	10	M6	35°
PRT-HK-100 ¹²⁾	205	185	22.5°	DIN 7984 M5	–	10	M6	40°
PRT-HK-200 ¹²⁾	320	300	22.5°	DIN 7984 M6	–	10	M6	40°

¹²⁾ To be connected only with enlarged outer ring

Manual clamp



- For type 01, size 60



Part No.
PRT-HK-60-K

Spacing rings made of anodized aluminum or polymer (POM)

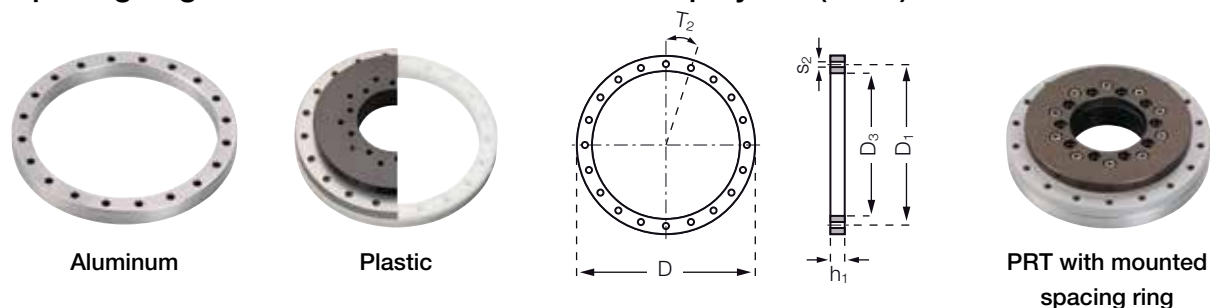

Dimensions [mm]

Part No. ³⁹⁾	D	D1	T2	S2	D3	h1
PRT-01-20-DR	80	70	6 x 60°	4.5	62	10
PRT-01-30-DR	100	91	8 x 45°	4.5	84	11
PRT-01-60-DR	160	145	20 x 18°	5.5	132	13
PRT-01-100-DR	185	170	16 x 22.5°	5.5	162	13
PRT-01-150-DR	250	235	16 x 22.5°	5.5	222	13
PRT-01-200-DR	300	285	16 x 22.5°	7.0	276	13
PRT-01-300-DR	450	430	16 x 22.5°	9.0	412	15

³⁹⁾ Please add suffix “-POM” for plastic version (not available for sizes 150 and 300)

Universal sliding elements

Customize your own slewing ring systems

Using the versatile iglide® PRT universal slide elements, large slewing ring systems can be tailored to the Type 01. Depending on the number of elements, slewing ring systems with internal diameters of 0.5 to 5 m are possible. We would be glad to assist you during the design stage.

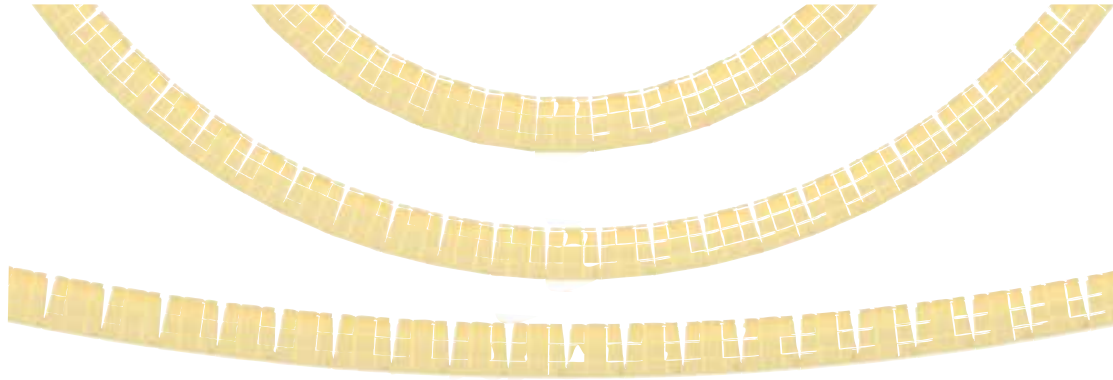

- Made from the proven iglide® J
- Slewing ring bearings possible from 0.5 up to 5 meters
- Low wear
- Sturdy, resistant to dirt
- Corrosion free and resistant to liquids
- Self-lubricating and maintenance-free



Basic construction of type 01:

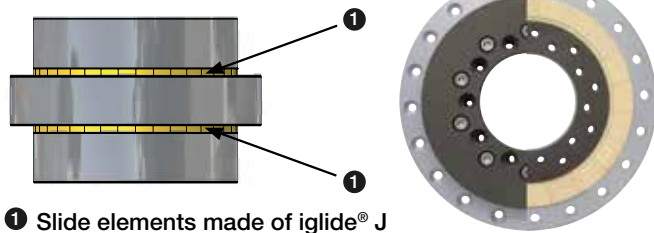

1 Slide elements made of iglide® J

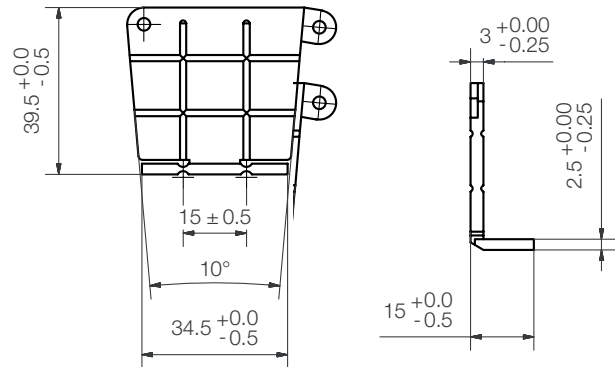

Part No.
 **JRS-500S/45S**

Notes

